

Fall 2025



# St. Francis Xavier Master Plan

• Architectural Documents Prepared by Davis Architects

# St. Francis Xavier By The Numbers

**1134**  
Families

**215**  
Baptisms last  
year

## St. Francis Xavier Catholic School

**170**  
Students

**84%**  
Catholic

**70%**  
Parishioners

**85**  
New Registered  
Families Each Year

**166**  
Confirmations last  
year

**40**  
OCIA Participants

**300**  
PSR Students

**250**  
Children & Adults in  
Hispanic Sacramental  
formation program

# What Makes SFX Great

**We are the largest church in the Diocese as measured by attendance at mass.**  
*Here are just a few of our many ministries.*



# Current Situation

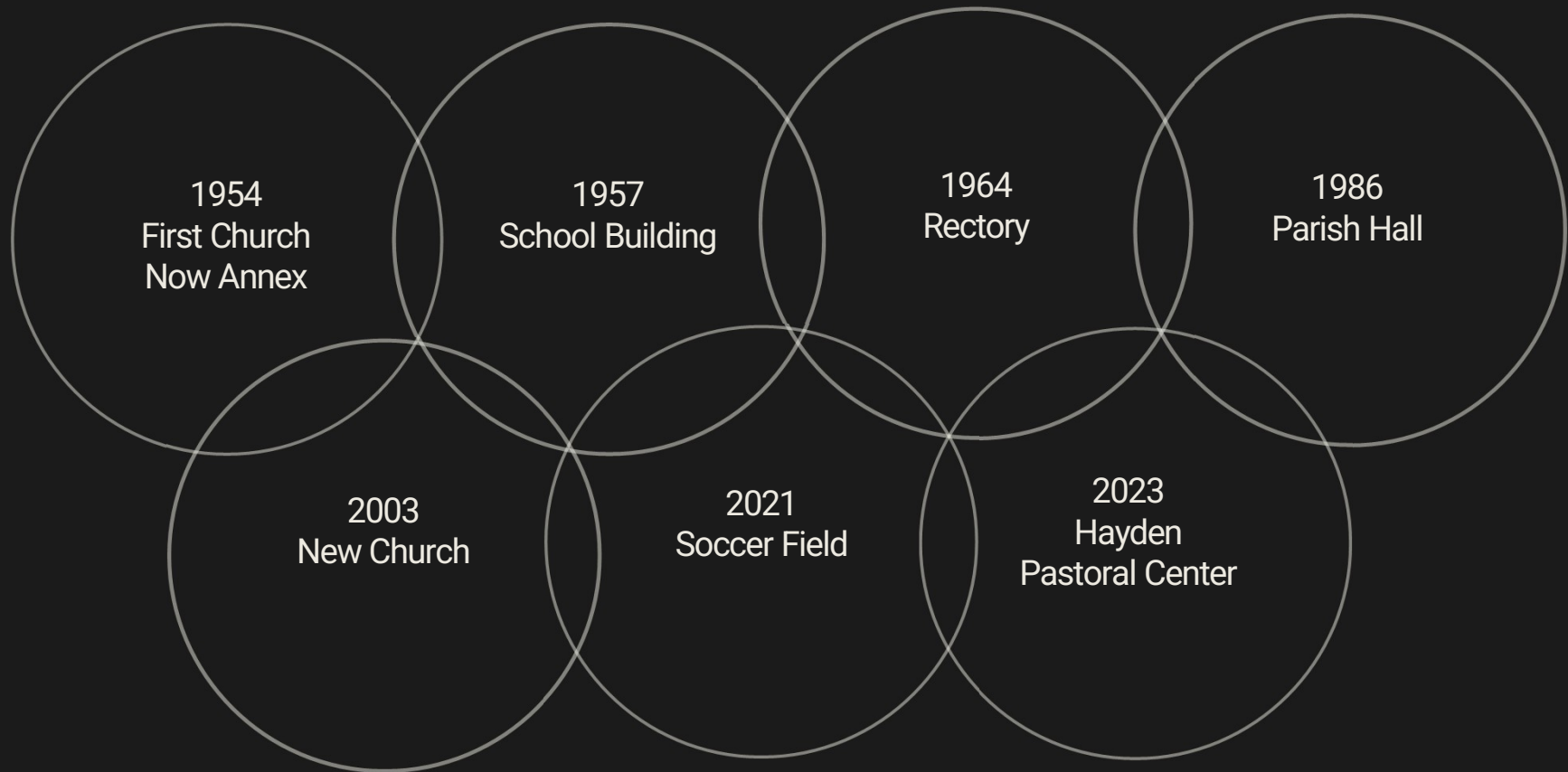

# Property Management Committee

---

## Meet Our Team

Our talented team of nine volunteers brings creativity, expertise, and dedication to St. Francis Xavier. This committee is charged with reviewing campus and making recommendations for maintenance and improvements to facilities and grounds.

Fr. Joe Culotta

Hugh Gainer

Tim Hennessy

Adrian Hughes

Nancy Jernigan

Charles McNamee

Ed Mitchell

Mary Paige Griffin

Kathy Kononchek



# Planning Process



# Capital Needs Assessment

## 1 Needs Assessment

After being informed of space and facility deficiencies, the PMC tasked Bob Sellers with performing a Capital Needs Assessment

---

## 2 Survey & Interviews

Parish groups and apostolates completed a survey and interviews.

---

## 3 List Review

The list was compiled and reviewed by PMC, Finance Committee, and Parish Council

---

## 4 Master Plan

Commissioned a comprehensive Master Plan for the parish campus.

---

## 5 Architect Selection

Davis Architects selected. They have only provided the plans you will see in the next slides for \$70K.

## 6 Committee Input

After much input from the parish group the refined plan was adopted as a Master Plan by PMC, FC, and PC.

# What is a Master Plan?

## ① Just Concepts

These are not construction documents but line drawing which show place holders for various needs.

---

## ② Plans Can Change

They can easily change based on the amount of money raised during the Capital Campaign or as needs change over time.

---

## ③ Parish Input

Parish input can also create changes in the plan.

---

## ④ Current Solution

This conceptual plan simply shows a version of how we can remedy all the Capital Needs deficiencies identified at this time.

---

**WE NEED YOUR INPUT!**



# Educational Building



# Educational Building Users



School

**170 Students**



PSR

**300 Students**



Nazareth House

# Major Deficiencies Identified in the Capital Needs Assessment

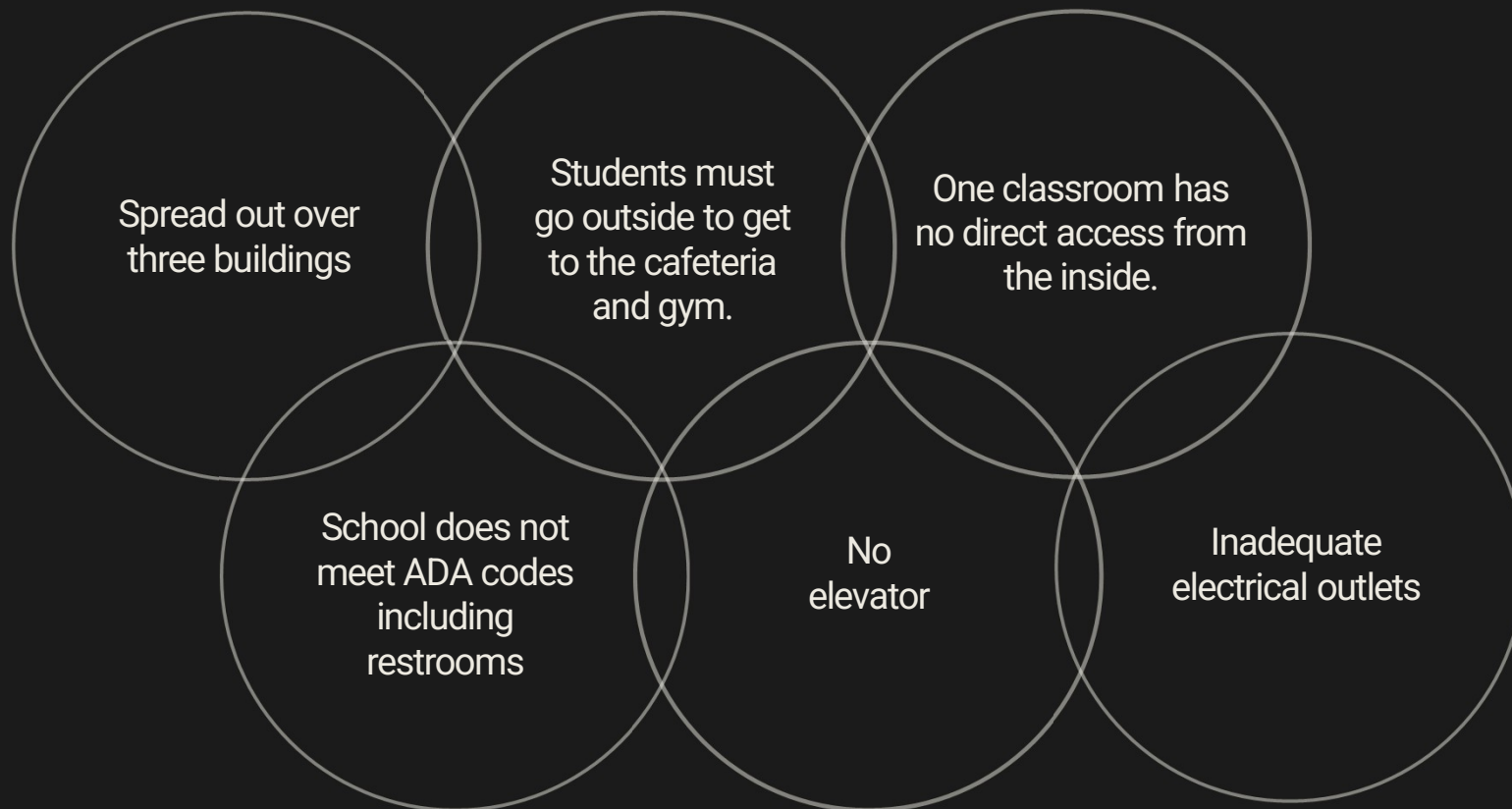



How the Master Plan addresses the



Deficiencies

# School Exterior Rendering



# Upper-Level



LEVEL 2

SCALE: 1/16" = 1'-0"

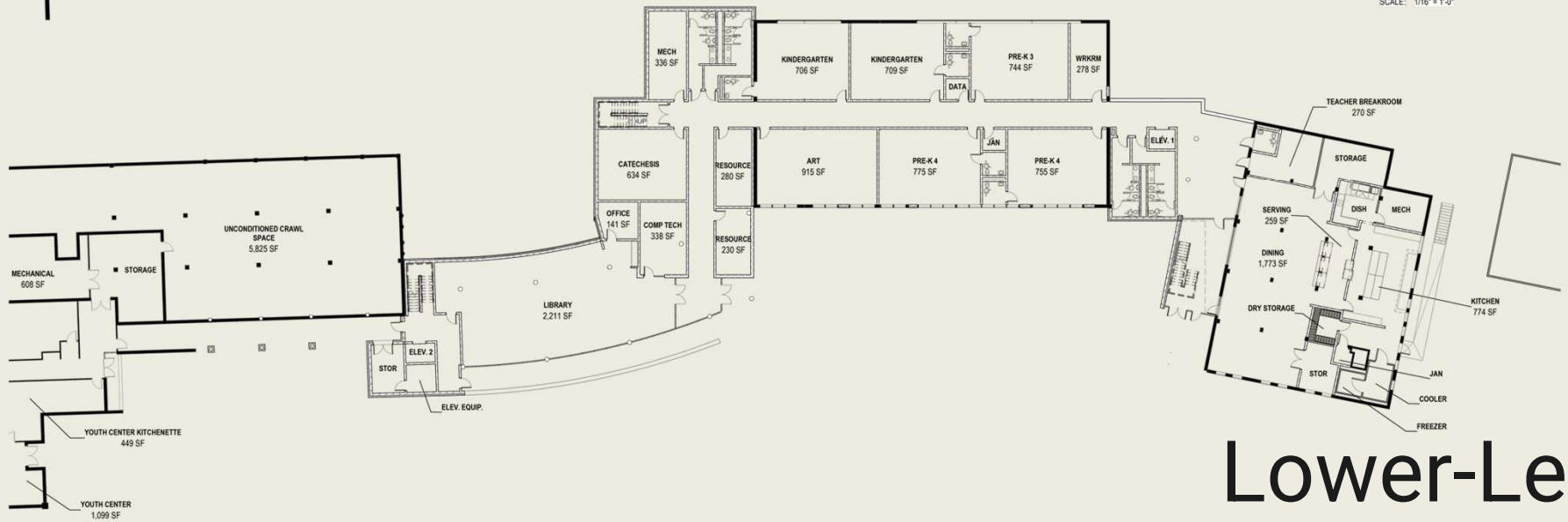

# Lower-Level

# Upper-Level – Grades 1<sup>st</sup> to 8<sup>th</sup> & Xavier Hall

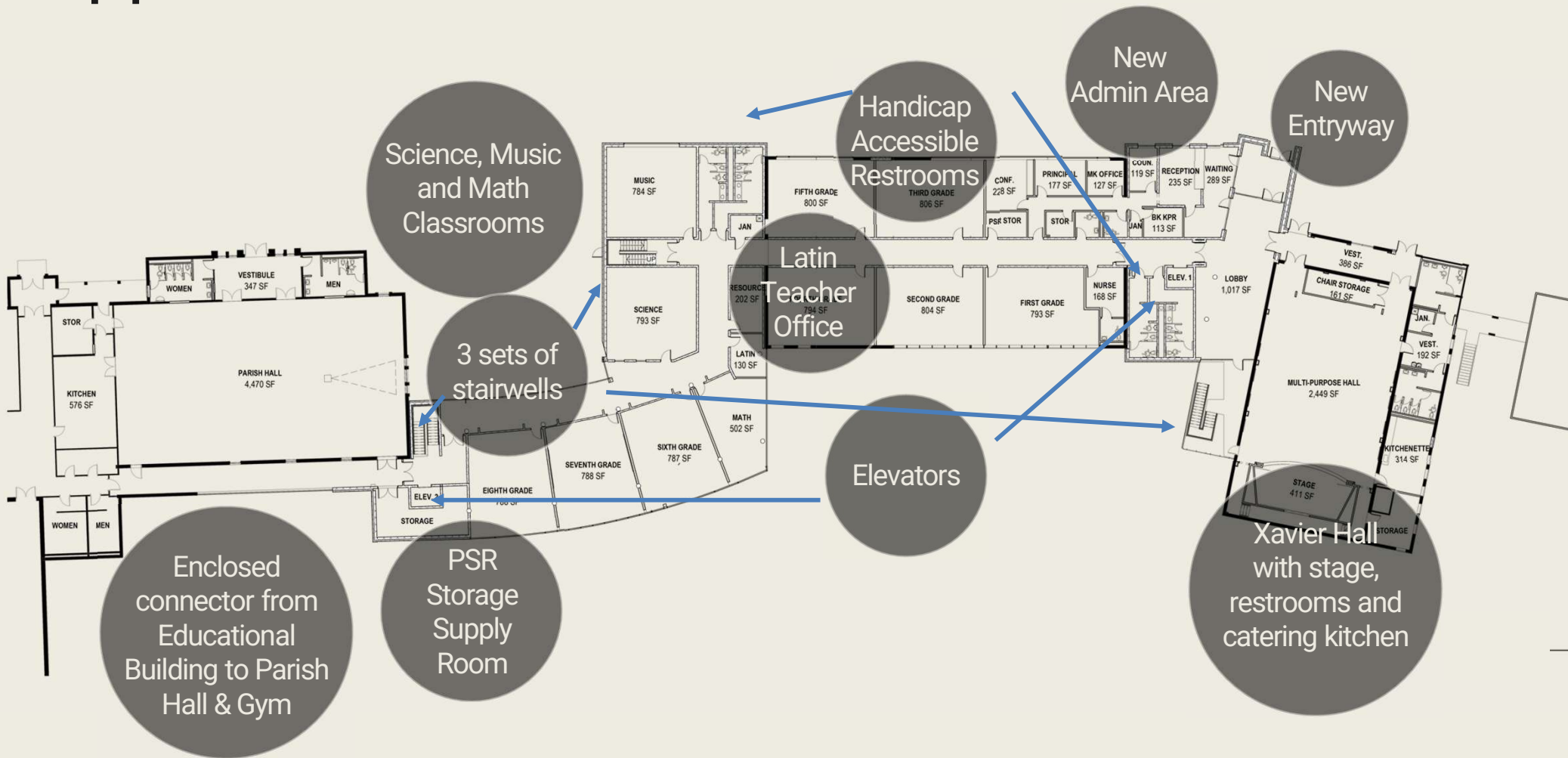

# Lower-Level – Kindergarten, Pre-K & Cafeteria

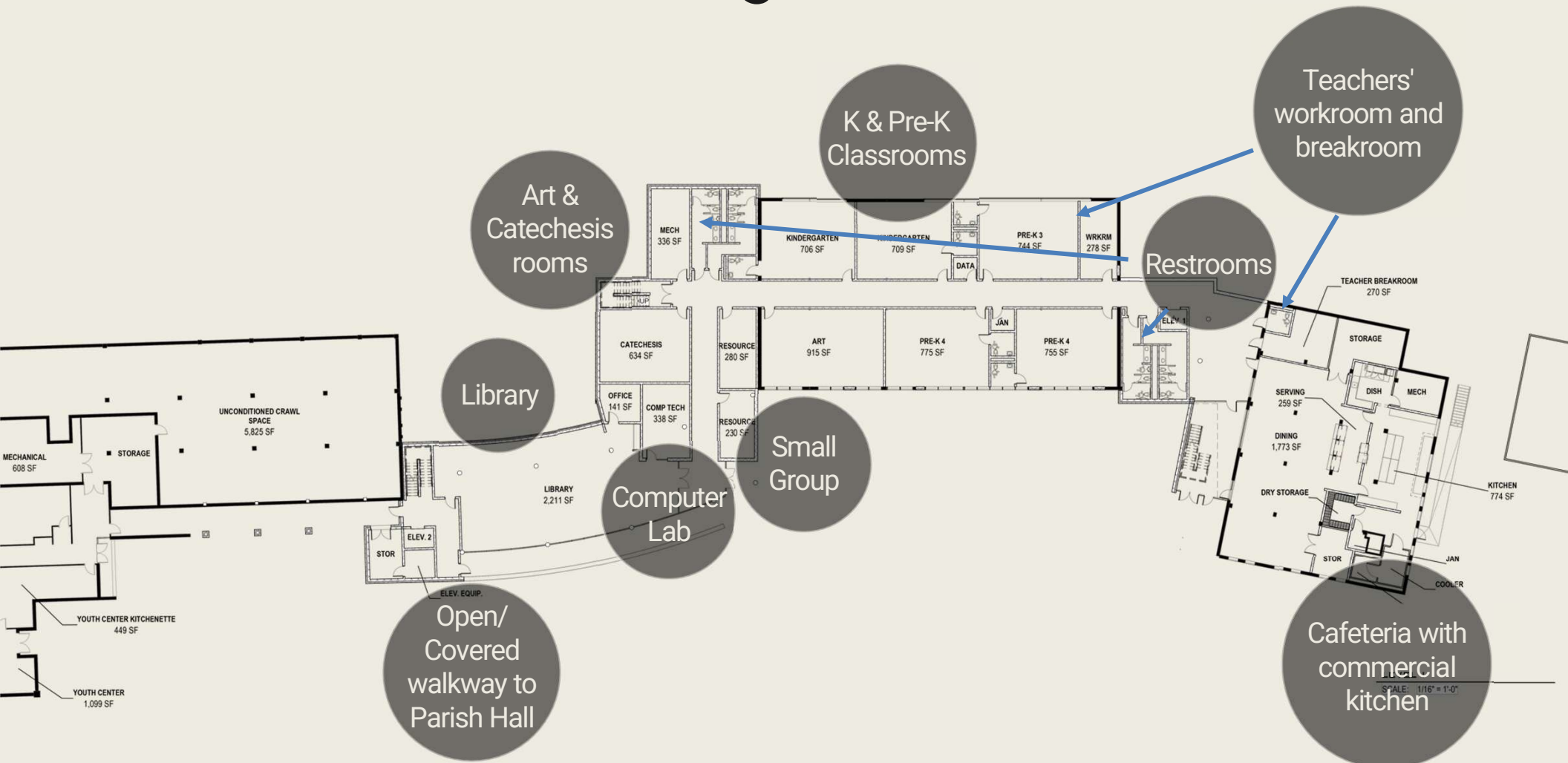

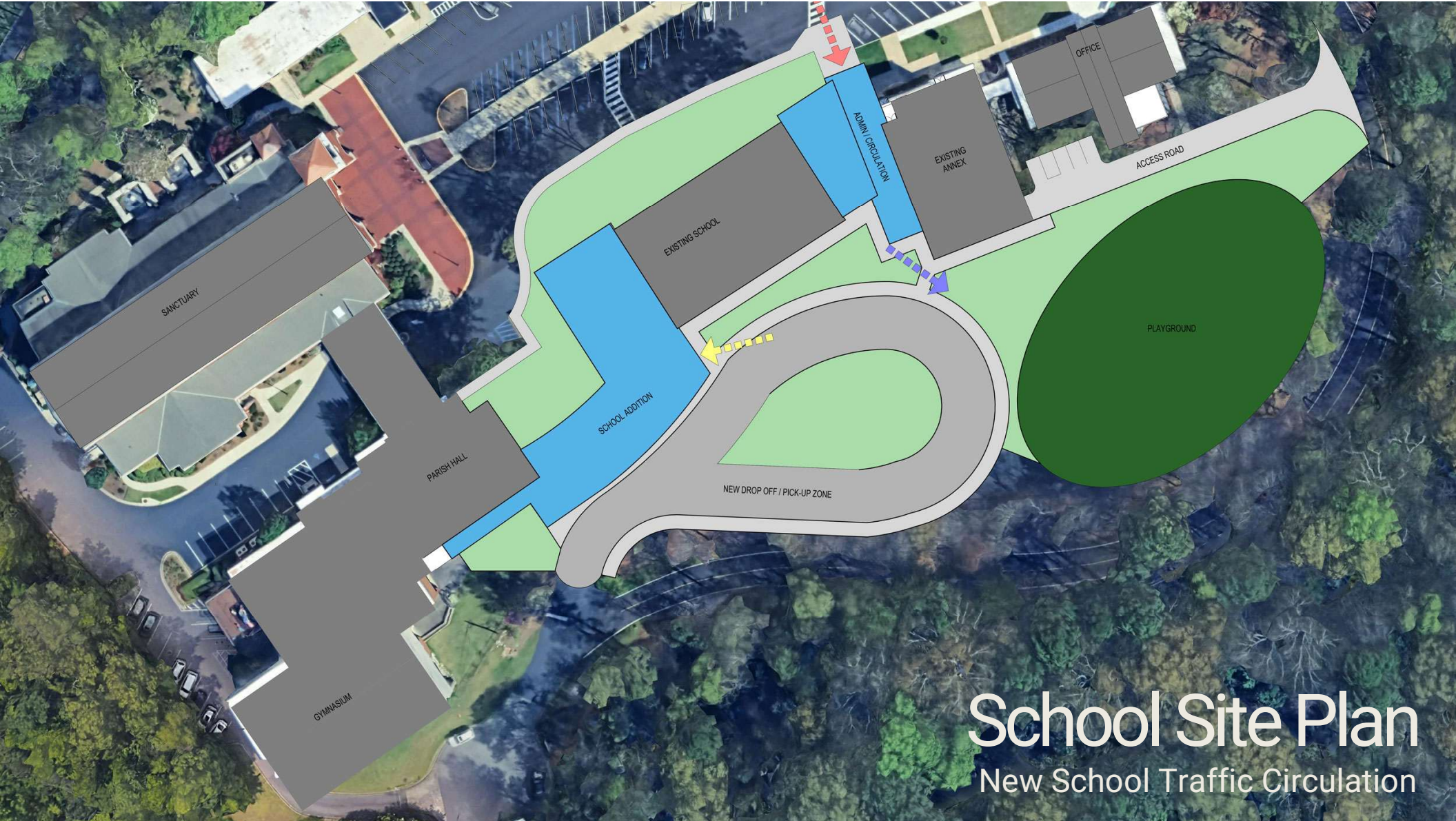

# School Site Plan

New School Traffic Circulation



Typical Classroom

# Typical Classroom



# Xavier Hall Interior





# Parish Hall

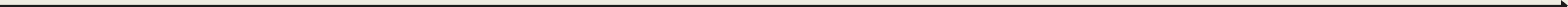

# Parish Hall Users

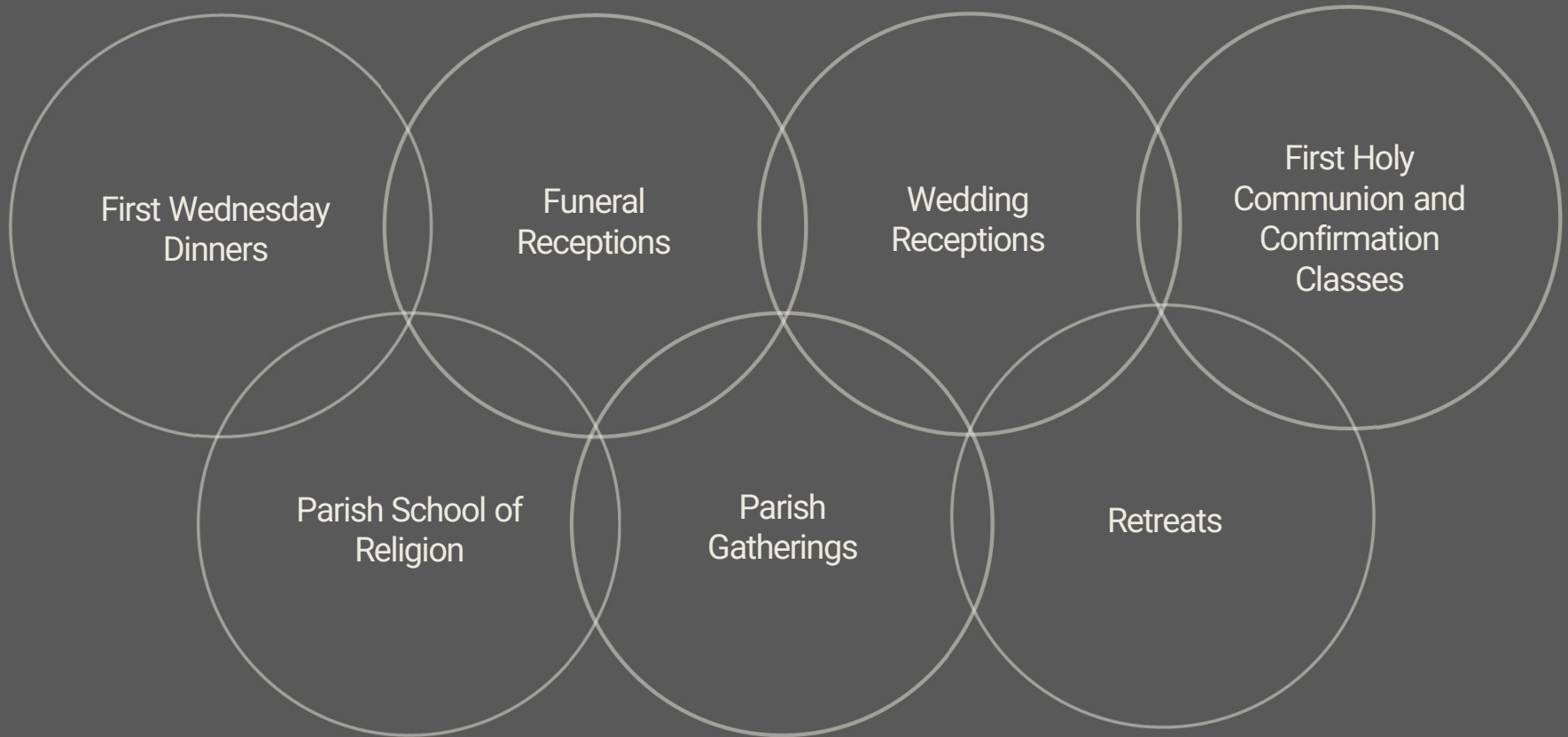

# Major Deficiencies Identified in the Capital Needs Assessment

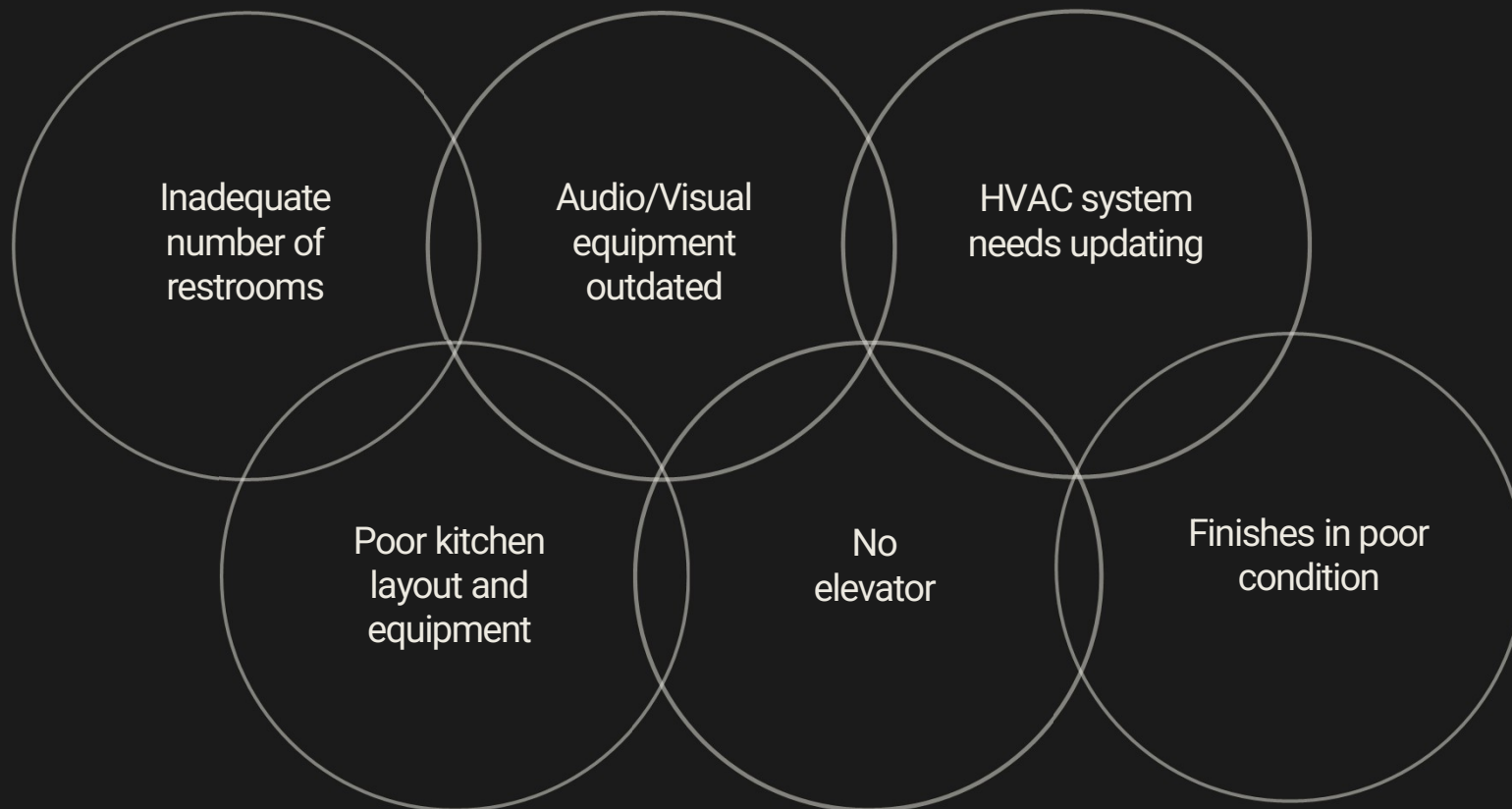



How the Master Plan addresses the



Deficiencies

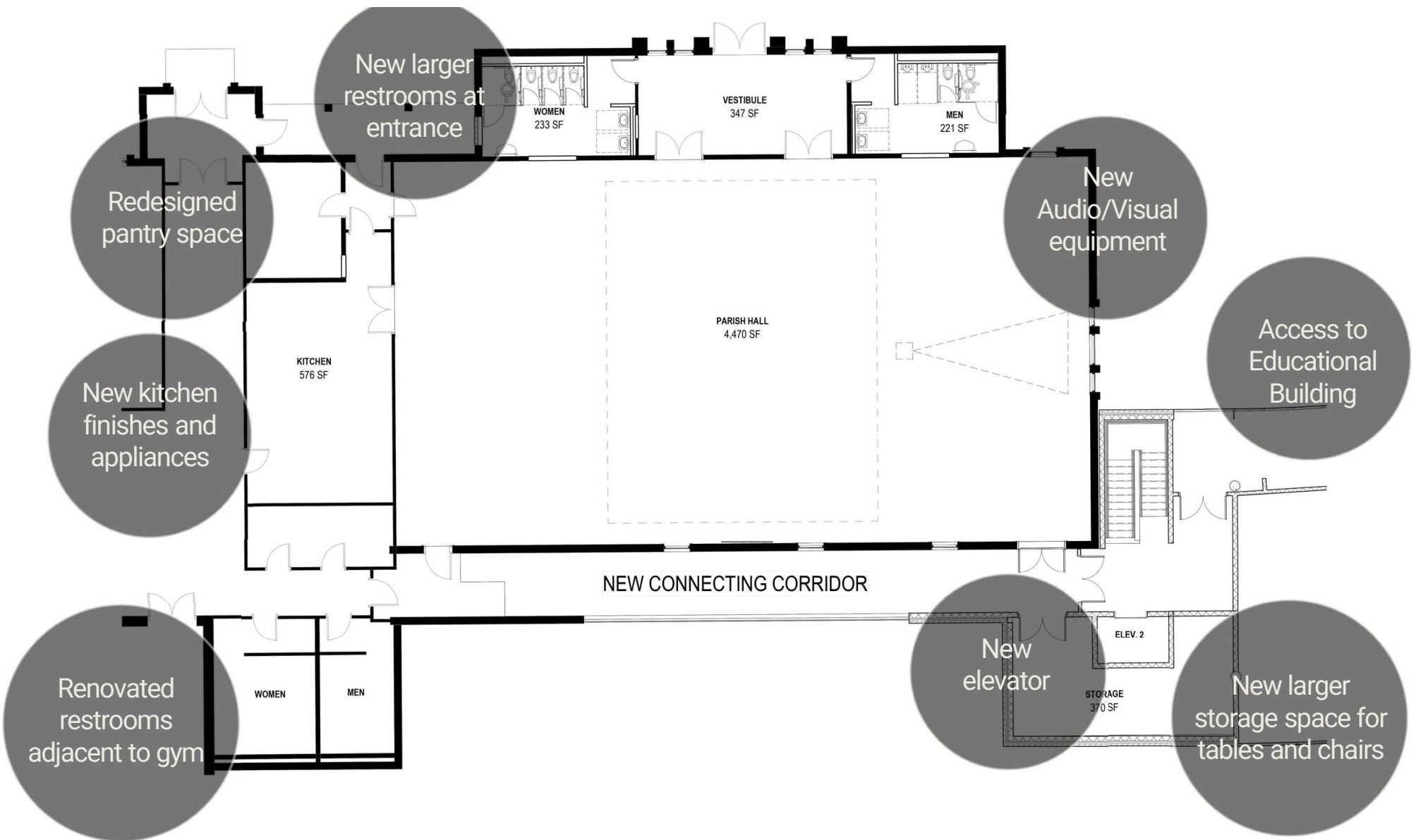

New larger restrooms at entrance

Redesigned pantry space

New kitchen finishes and appliances

Renovated restrooms adjacent to gym

New Audio/Visual equipment

Access to Educational Building

New elevator

New larger storage space for tables and chairs

WOMEN  
233 SF

VESTIBULE  
347 SF

MEN  
221 SF

KITCHEN  
576 SF

PARISH HALL  
4,470 SF

NEW CONNECTING CORRIDOR

ELEV. 2

STORAGE  
370 SF

WOMEN

MEN





Reimagined  
Ceiling

New finishes on  
interior walls



# Soccer Field

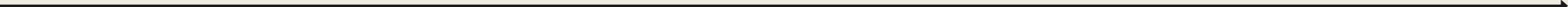

# Major Deficiencies Identified in the Capital Needs Assessment





How the Master Plan addresses the



Deficiencies



MARYJOSEPH  
CONNECTION

# Campus Site Plan



# Estimated Pricing





# What do the changes presented accomplish – Phase 1

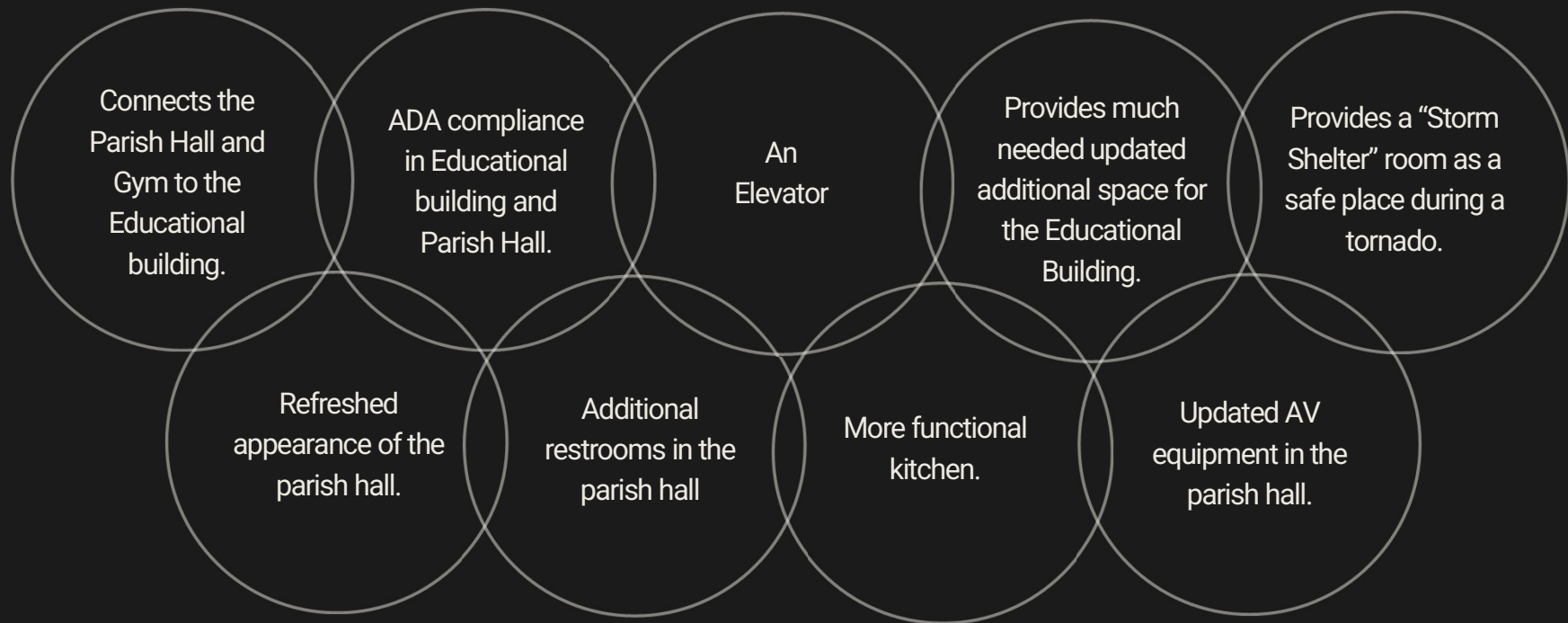

# Questions and Comments

